

ITEM #: \_\_\_\_\_ QTY: \_\_\_\_\_  
 MODEL #: \_\_\_\_\_  
 PROJECT NAME: \_\_\_\_\_

022318

3601 S. Banker St. Effingham, IL 62401 • P.O. BOX 609 • Ph: (888) 431-2667 • Fax: (800) 433-2667

## **"CU-CB" CHEF'S BLOCK**

### **FEATURES:**

- HARD MAPLE END GRAIN TOP, STANDARD BOOS BLOCK CREAM FINISH WITH BEESWAX
- AVAILABLE WITH OR WITHOUT A PAINTED SLATTED SHELF
- SEE BASE COLOR SPEC SHEET FOR COLOR OPTIONS



CU-CB3024S-BN



CU-CB3024-CR

### **CHEF'S BLOCK**

MODEL #	QTY
CU-CB3024	
CU-CB3024S	

## DETAILED SPECIFICATIONS

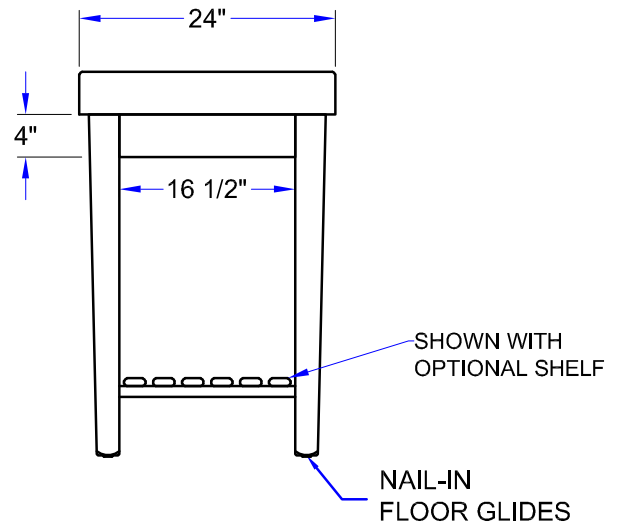
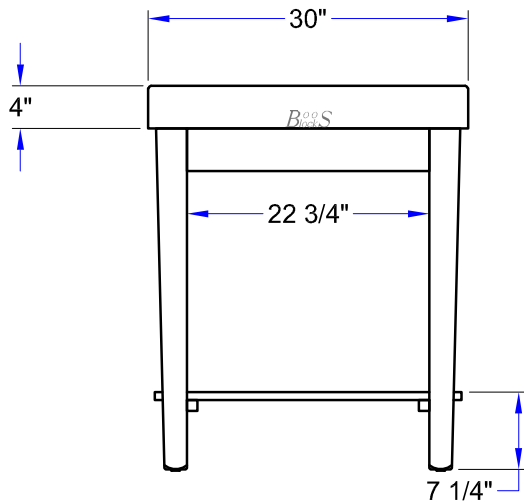
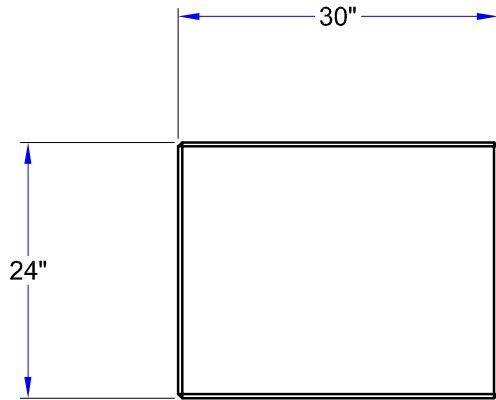

### CHEF'S BLOCK

MODEL #	SIZE	DESCRIPTION	HEIGHT	WEIGHT (LBS)
CU-CB3024	30" X 24" X 4"	W/OUT PAINTED SLATTED SHELF	36"	110
CU-CB3024S	30" X 24" X 4"	W/ PAINTED SLATTED SHELF	36"	115

SOME UNITS SHIP UNASSEMBLED FOR REDUCED SHIPPING COST. ALL DIMENSIONS ARE TYPICAL. TOLERANCE +/- .500"  
 John Boos & Co. is constantly engaged in a program of improving products and therefore reserves the right to change specifications without prior notice.



3601 S. Banker St. • Effingham, IL 62401 • PO BOX 609 • quotes@johnboos.com

022318

Boos  
lock

AQ AutoQuotes

www.johnboos.com

157